

Filling Guide

EZ FLOWTM ELASTOMERIC PUMP

-
- 02 EZ-FLOWTM ELASTOMERIC OVERVIEW

 - 04 SHORT DURATION INSTRUCTIONS

 - 05 SHORT DURATION FILL TIMES

 - 06 LONG DURATION & CHEMOTHERAPY INSTRUCTIONS

 - 07 LONG DURATION FILL TIMES

OVERVIEW

EZ-FLOW™ Elastomeric Pumps are proven to be safe and effective and are a convenient alternative to electronic infusion pumps. Ideally suited for infusion, long-term care, and outpatient chemotherapy treatments, EZ-FLOW pumps give the patient mobility and freedom to maintain an active lifestyle.

The EZ-FLOW Elastomeric Pump is easy to fill and color-coded for quick and accurate device identification. The wide range of SKUs available offers dosing flexibility to administer various infusion therapies at different flow rates. Please refer to the Fill Volume and Delivery Time Tables within this guide to help determine which product is best suited for the needed therapy.

FILL VOLUMES & DELIVERY TIMES*

The EZ-FLOW Elastomeric Pump nominal flow rates are based on sodium chloride (0.9%, 31° C/88° F) as reference. Use of 5% dextrose will result in 10% slower flow rate or correspondingly 10% longer delivery time.

- Actual infusion time may vary depending on fill volume, flow rate and other influencing factors. View "Factors Influencing Flow Rate Chart" at integratedmedsys.com/FlowRateFactors for details.
- Delivery times for partial or overfill volumes are approximate values.
- Filling the pump more than the nominal fill volume results in a slower flow rate.
- Filling the pump less than nominal fill volume results in a faster flow rate.
- Do not fill the pump less than the minimal or more than the maximum fill volume specified.
- Filling the up with diluent before adding the drug/medication is recommended.

*Refer to the tables on the following pages to determine the appropriate pump model based on the fill volume and desired delivery time. Residual volume information is also included.

DRUG STABILITY

Drug Stability data is available on a wide range of medications. The Drug Stability Guidelines for the administration of medications using the EZ-FLOW™ Elastomeric Pump were developed as a result of testing performed by independent laboratories, review of various medical publications and manufacturers’ product information, and available elastomeric infusion pump drug stability data.

The pharmacist dispensing the drug is responsible for ensuring proper preparation using validated aseptic techniques to prevent microbiological contamination. For practice and quality standards, refer to USP <797> Pharmaceutical Compounding – Sterile Preparations and USP <800> Hazardous Drugs - Handling in a Healthcare Setting.

To view the full Drug Stability Guide data table, scan the QR code or visit go.integratedmedsys.com/DrugStability



STORAGE*

The EZ-FLOW Elastomeric Pump should be stored between 68° F to 77° F and protected from light sources and heat prior to filling with medication. Prior to the start of infusion, the elastomeric pump and contents should at room temperature.

The table below provides guidelines for the estimated time the pump will take to reach room temperature after refrigeration based on the nominal fill volume. Elastomeric pumps should not be stored in a freezer.

ESTIMATED TIME TO REACH ROOM TEMPERATURE BASED ON VOLUME			
Fill Volume (mL)	Remove from Refrigerator (hrs)	Remove from Freezer (hrs)	
50	6	12	
60	7	12	
100	8	16	
125	8	16	
270	12	25	
300	12	25	
400	15	29	
500	18	30	

*Refer to the drug manufacturers’ requirements for storage after filling the pump with medication.

SHORT DURATION

INSTRUCTIONS FOR FILLING

1

Prepare the Equipment

Unscrew the fill port cap.
Keep the pinch clamp in the closed position.
Attach the prepared filling device securely to the fill port.

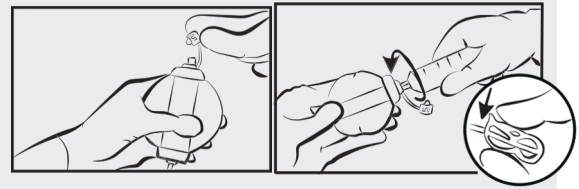

2

Fill the EZ-FLOW™ Pump

Fill using a syringe or pump.
Always use the recommended fill volume.

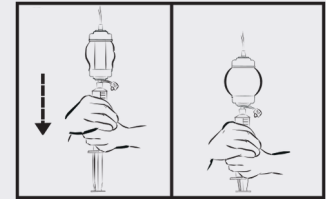

3

Label & Store Appropriately

Detach filling device from the fill port screw on the fill port cap.
Label with appropriate pharmaceutical and patient information.

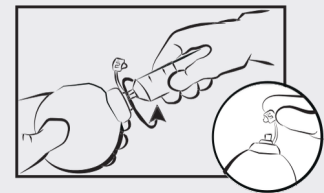

PRIMING ADMINISTRATION TUBING

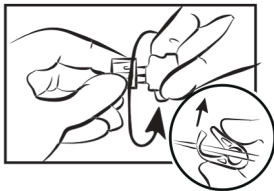

Move pinch clamp to the open position.



Loosen the patient end cap until medication begins to flow down tubing.

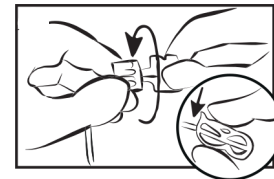

When all air is expelled, retighten the patient end cap. Move the pinch clamp to the closed position.

DRUGS PRONE TO PRECIPITATION

1. Fill the EZ-FLOW elastomeric with 10 mL of diluent.
2. Prime the administration tubing.
3. Fill the remaining volume with diluent and medication.

***The diluent will fill the entire tubing, protecting it from precipitation, while the pump reservoir will contain the full medication dose.**

Short Duration Fill Volume, Flow Rate, & Duration

Item #	Nominal Fill Volume (mL)	Min. Fill Volume (mL)	Max. Fill Volume (mL)	Residual Volume (mL)	Color Code	Nominal Flow Rate (mL/Hr)	Nominal Duration (Minutes)
IM050050S	50	50	60	2		50	60
IM100050S	100	75	110	2		50	120
IM100100S	100	50	120	2		100	60
IM100200S	100	50	120	2		200	30
IM200100S	200	150	250	3		100	120
IM200200S	200	150	300	2		200	60
IM250050S	250	150	300	3		50	300
IM250100S	250	200	300	3		100	150
IM250125S	250	150	300	3		125	120
IM250175S	250	140	300	3		175	90
IM250250S	250	150	300	3		250	60
IM250500S	250	200	230	3		500	30
IM270175S	270	150	300	3		175	90
IM400100S	400	275	550	5		100	240
IM400200S	400	200	500	5		200	120
IM500250S	500	360	550	5		250	120

LONG DURATION & CHEMOTHERAPY

INSTRUCTIONS FOR FILLING

1

Prepare the Equipment

Unscrew the fill port cap.
Keep the pinch clamp in the open position.
Attach the prepared filling device securely to the fill port.



2

Fill the EZ-FLOW™ Pump

Fill using a syringe or pump.
Always use the recommended fill volume.

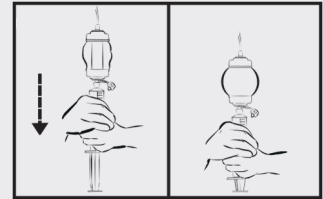

3

Label and Store Appropriately

Detach filling device from the fill port.
Screw on the fill port cap & close pinch clamp.
Label with appropriate pharmaceutical and patient information.

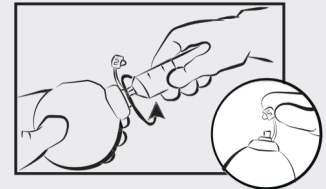

Priming Cap Automatically Primes

Long Duration and Chemotherapy EZ-FLOW™ Elastomeric Pumps include a priming cap.

The priming cap enables the administration tube to be automatically primed and ready for infusion. The membrane prevents fluid from leaking out of the priming cap, allowing air to escape.

Drugs Prone to Precipitation

1. Fill the EZ-FLOW elastomeric with 10mL of diluent.
2. Prime the administration tubing.
3. Fill the remaining volume with diluent and medication.

***The diluent will fill the entire tubing, protecting it from precipitation, while the pump reservoir will contain the full medication dose.**

Fill Volume, Flow Rate, & Duration

Item #	Nominal Fill Volume (mL)	Min Fill Volume (mL)	Max Fill Volume (mL)	Residual Volume (mL)	Color Code	Nominal Flow Rate (mL/Hr)	Nominal Duration (Minutes)
IM060005L	60	30	100	2		5	12
IM100002L	100	75	110	2		2	50
IM100005L	100	75	120	2		5	20
IM125005L	125	75	150	2		5	25
IM270001L	270	240	270	3		1	270
IM270002L	270	150	300	3		2	135
IM270004L	270	230	300	3		4	67
IM270005L	270	250	360	3		5	54
IM270010L	270	230	360	3		10	27
IM500020L	500	360	500	5		20	25
IM100002C	100	75	120	2		2	50
IM125005C	125	75	150	2		5	25
IM270002C	270	150	300	3		2	135
IM270005C	270	240	330	3		5	54
IM270010C	270	230	360	3		10	27
IM300006C	300	250	360	3		6	50

LONG DURATION

CHEMOTHERAPY

Carrying Pouches



- Use with Elastomeric Pumps
- Adjustable Straps
- Zipper Pouch
- Available in Blue

Chemotherapy Spill Kit



- 2 Chemo-rated Pairs of Gloves
- 1 Chemo Waste Bag
- 1 Antiseptic Towelette
- 1 Ultrisorbs Towel

Ordering Details

Item #	Description	Size	UOM
IM58010	IMed Elastomeric Pump Pouch	200mL	1/Each
IM58011	IMed Elastomeric Pump Pouch	500mL	1/Each
IM46119	Chemotherapy Spill Kit	N/A	50/Case

Ready to take action?

Scan the QR code to place your order or find out more!



Leading the healthcare industry towards a more efficient and effective future through our commitment to excellence in developing cutting-edge medical products and solutions.

Proudly Distributed by:



To order, contact your IMS Territory Manager or Customer Service at 800.755.3800

The product details provided herein, including any images or supplements, reflect information from various sources regarding the product; this information has not been independently verified by Integrated Medical Systems ("IMS") or its affiliates. IMS is not liable for any inaccuracies or omissions in the product information, which is provided solely for your convenience.

The information presented here is subject to change without prior notice. Customers should review product packaging and labeling before use or purchase to ensure accuracy, especially when referencing information from IMS's online or printed materials. IMS disclaims any responsibility for the accuracy or completeness of the information reflected herein, regardless of whether any inaccuracies or omissions are due to errors or other factors.