

Patient Guide



EZ FLOWTM ELASTOMERIC PUMP

- 01 OVERVIEW, HOW IT WORKS, GETTING STARTED
- 02 PUMP DIAGRAM
- 03 PATIENT INFORMATION
- 04 PREPARE FOR TREATMENT
- 04 INFUSING MEDICATION
- 05 TROUBLESHOOTING, LEAKS & SPILLS, PRECAUTIONS
- 06 EZ-FLOWTM ACCESSORIES

EZ FLOW™

ELASTOMERIC PUMP

OVERVIEW

The EZ-FLOW™ Elastomeric Pump is a simple, battery-free device that safely delivers medication for infusion treatments like pain management or chemotherapy.

It's easy to use at home, allows patients to stay active, and offers a reliable alternative to more complex electronic pumps.

HOW IT WORKS

The balloon-like reservoir is filled with medication. This reservoir applies gentle pressure, releasing the medication at a steady rate. The flow rate (how fast medication is released) is controlled by a small restrictor (6) and the tubing. You can check your flow rate by looking at the color-coded label on the filter or top of the pump.

GETTING STARTED

Your doctor will help you fill out your patient information on the next page. Be sure to note the treatment duration and any storage instructions.

PRODUCT DIAGRAM

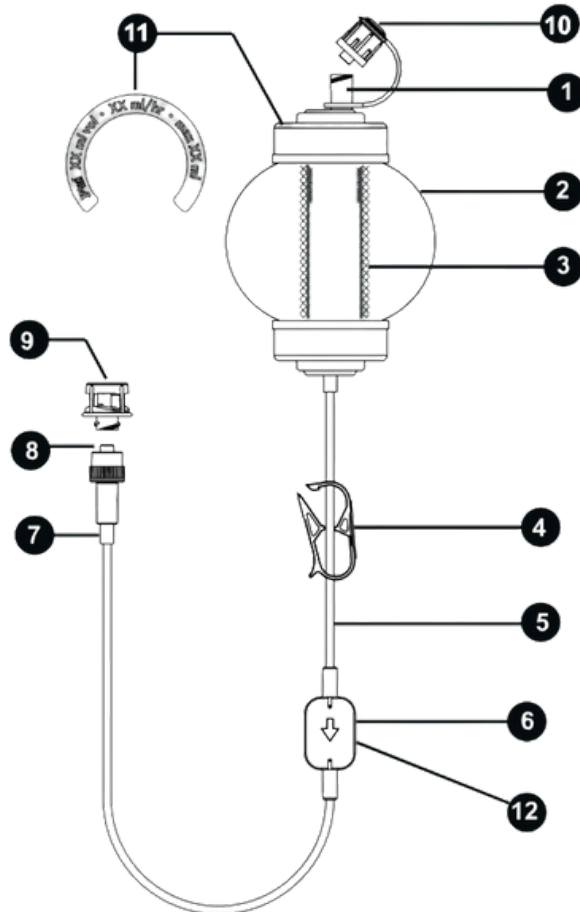

1. Fill Port
2. Outer Soft Cover
3. Multi-Layered Elastomeric Membrane
4. On-Off Clamp
5. Non-DEHP PVC Administration Tubing
6. Air and Particulate Eliminating Filter
7. Flow Restrictor
8. Patient Connector
9. Non-Vented Cap (Short Duration Models) / Priming Cap (Long Duration & Chemotherapy Models)
10. Tethered Fill Port Cap
11. Fill Volume & Flow Rate Label
12. Flow Rate Label

PATIENT INFORMATION

Patient Name: _____

Medication Name: _____ Dose: _____

Healthcare Provider Phone Number: _____

Treatment Start Time(s): _____

Length of Treatment (approx.): _____

Pump Information

Pump Tubing:

Primed (filled with medication) Not Primed (not filled with medication)

Store pump in:

Room temperature Refrigerator Freezer

Remove the EZ-FLOW™ Elastomeric Pump from storage _____ hours before use.

Close tubing clamp to stop infusion and immediately contact your health care provider if you experience any of the following side effects:

Catheter/Access Device Instructions:

PREPARE & INFUSE MEDICATIONS

Follow these steps carefully to ensure the infusion process is safe and effective. If you have any problems or questions, contact your healthcare provider right away.

1) Clean and prepare your access site.

- Wash your hands thoroughly. Then, follow your healthcare provider's instructions on how to properly clean and prepare your access site for treatment.

2) Confirm your medication.

- Make sure that your EZ-FLOW™ is correctly labeled with your name, medication, dose, and that the expiration date is still valid. NOTE: If any information is incorrect, DO NOT USE the pump and contact your healthcare provider.
- Check that your medication and EZ-FLOW have reached room temperature. NOTE: If the medication and pump are too cold, it may take longer to infuse the medication. (See table below for estimated time to room temperature based on medication volume.)
- Confirm the patient end cap and fill port are tightly secured, and make sure the pinch clamp is in the closed position.

3) Connect your pump.

- Remove the patient end cap from your EZ-FLOW tubing and attach the connector on the pump to your clean access site. Do not over-tighten.
- Ensure your access site is secure and free of kinks by taping the tubing to your skin.



ESTIMATED TIME TO REACH ROOM TEMPERATURE BASED ON VOLUME

Fill Volume (mL)	Remove from Refrigerator (hrs)	Remove from Freezer (hrs)
50	6	12
60	7	12
100	8	16
125	8	16
270	12	25
300	12	25

Once your EZ-FLOW™ Elastomeric is connected and your medication has reached room temperature, you are ready to start your infusion treatment.

Starting Treatment

- The pump will be full and hard to the touch.
(See Illustration A)
- Open the pinch clamp to start the infusion.
- Note the start time and calculate the estimated end time based on your estimated treatment duration.
- Do not squeeze the pump; the medication will flow on its own.



Illustration A

During Treatment

- Pump Deflation: The EZ-FLOW Elastomeric Pump will steadily shrink as it delivers the medication.
(See Illustration B)
- External Pressure: Do not apply extra pressure to the pump, as this could speed up the flow rate and cause the pump to break.
- Carrying: Place the pump in a carrying case, pocket or table next to you. The pump should be the same level as your access site.
- Water: Prevent the filter from getting wet and do not submerge the pump in water. Ask your healthcare provider if it's safe to bathe or shower with the pump.
- Sleeping: Place the pump on a bedside table or on top of the covers. Do not place on floor or underneath bed covers where the pump may move away from your access site or get too warm.



Illustration B

Finishing Treatment

- Your treatment is finished when the pump is completely deflated, empty, and you can feel the inner core.
(See Illustration C)
- If you're unsure about the treatment duration, refer to the first page or contact your healthcare provider.
- Disconnect the pump tubing from your access site and dispose of it as directed by your healthcare provider.
Do not reuse.



Illustration C

TROUBLESHOOTING

If your pump isn't working properly, first check the following:

- Room Temperature: Make sure the pump and medication are at room temperature.
- Pinch Clamp: Ensure the pinch clamp is open and moves freely up and down the tubing.
- Clamps and Filter: Verify that all clamps on the catheter are open and that the filter isn't covered.
- Tubing: Check that there are no kinks in the tubing.

If everything appears correct and the pump still isn't working, contact your healthcare provider for further instructions.

Leaks and Spills

If there is a leak or spill:

1. Close the pinch clamp immediately.
2. Wash off any medication that has come into contact with your skin right away.
3. Contact your healthcare provider immediately for guidance.
4. Save the pump and give it to your healthcare provider so it can be returned to the manufacturer.

Precautions

- Do not submerge the pump in water.
- Prevent the filter from getting wet.
- Make sure the tubing is free of kinks and the pinch clamp is in the ON/OPEN position for full infusion time. If kinks are observed in the tubing, roll the tubing between your fingers to release the kink.
- Do not get alcohol or detergents on the filter as this may cause a leak.
- Do not sleep on the pump.
- Do not squeeze or play with the filled pump. Applied pressure may result in rupture or breakage and will result in increased flow rate.
- Avoid prolonged periods of extreme heat or cold.
- Ensure the pump and medication have reached room temperature prior to treatment.

Carrying Pouches

- Use with Elastomeric Pumps
- Adjustable Straps
- Zipper Pouch
- Available in Blue



Item #	Description	Size	UOM
IM58010	IMed Elastomeric Pump Pouch	200mL	1/Each
IM58011	IMed Elastomeric Pump Pouch	500mL	1/Each

Chemotherapy Spill Kits

- 2 Chemo-rated Pairs of Gloves
- 1 Chemo Waste Bag
- 1 Antiseptic Towelette
- 1 Ultrasorbs Towel



Item #	Description	UOM
IM46119	Chemotherapy Spill Kit, Basic	30/Case

The product details provided herein, including any images or supplements, reflect information from various sources regarding the product; this information has not been independently verified by Integrated Medical Systems ("IMS") or its affiliates. IMS is not liable for any inaccuracies or omissions in the product information, which is provided solely for your convenience.

The information presented here is subject to change without prior notice. Customers should review product packaging and labeling before use or purchase to ensure accuracy, especially when referencing information from IMS's online or printed materials. IMS disclaims any responsibility for the accuracy or completeness of the information reflected herein, regardless of whether any inaccuracies or omissions are due to errors or other factors.

© 2025 INTEGRATED MEDICAL SYSTEMS, INC. (IMS) | ALL RIGHTS RESERVED