



Vivo 45LS

Quick Reference Guide

for Lay Caregiver



This is not a complete guide for the Vivo 45LS.
See your manual for complete instructions.

Connection to Power

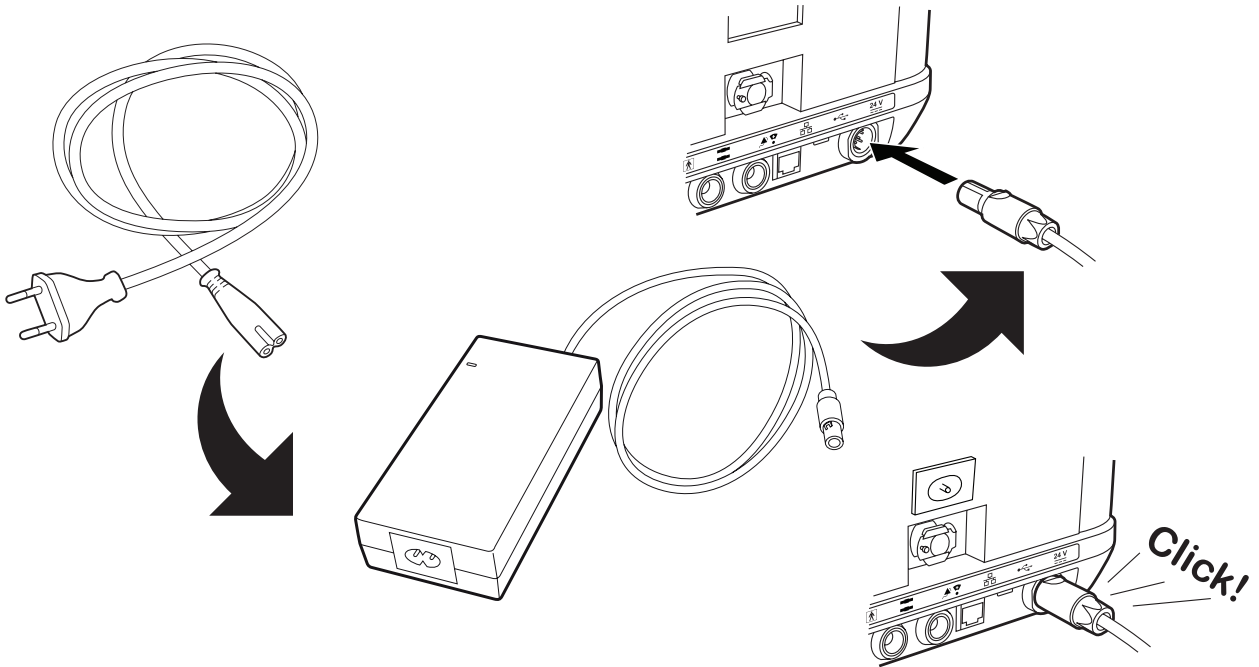

Connecting a Patient Circuit

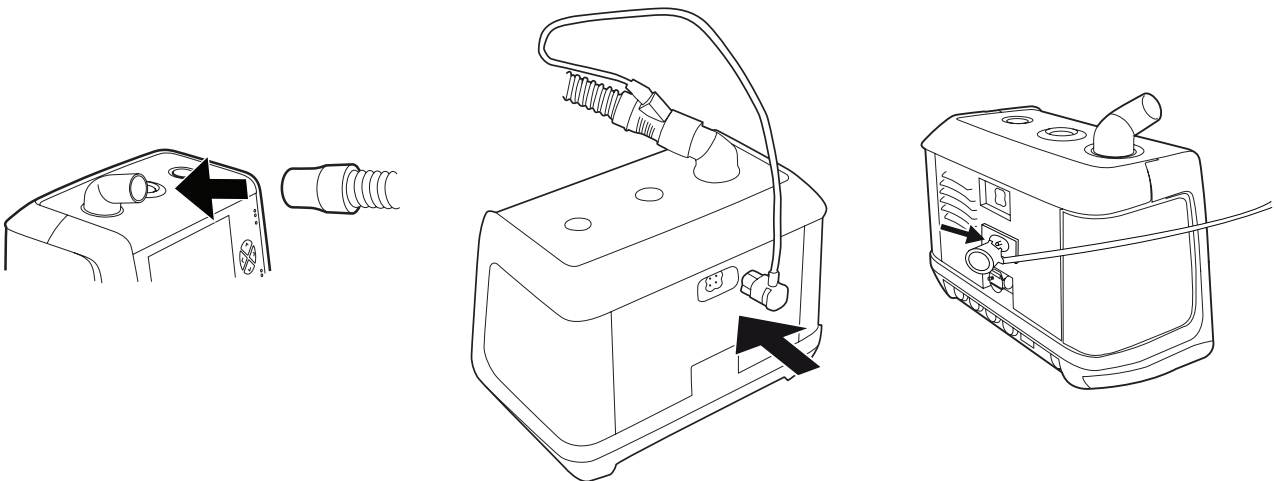

Connect the patient circuit

If using a heated wire circuit
connect wire to back

If using an exhalation valve
circuit connect pressure
tube to back

Start Treatment

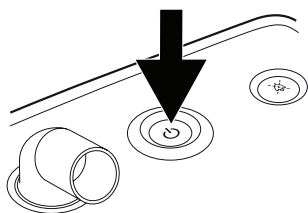

Press and Hold
Start/Stop until beep
Pre-Use Test is not
needed if same circuit is
being used

Stop Treatment

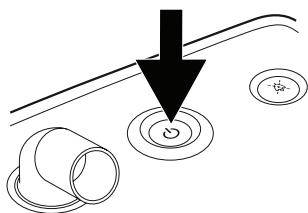

Press and Hold
until beep then

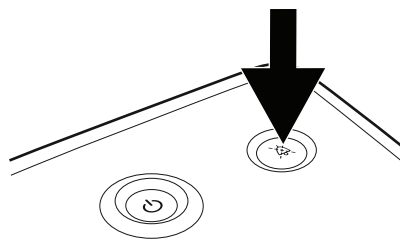

Press **Audio Pause Button**

Turn Off

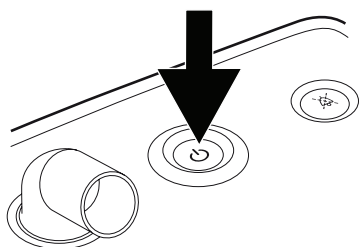

Press **Start/Stop**

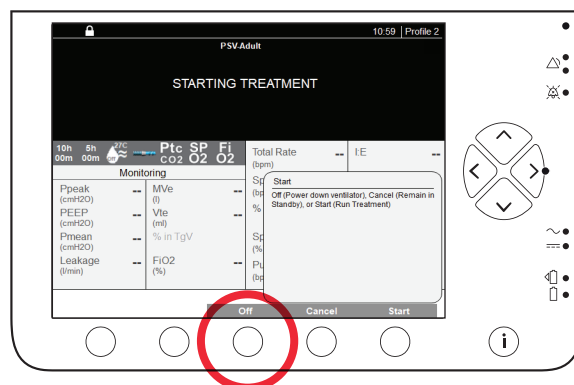

Press Button Under "**Off**"

Silence Existing Alarm

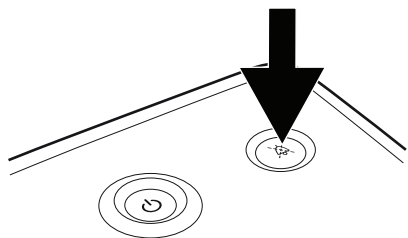

Press **Audio Pause Button**

Silence All Alarms for 2 Minutes

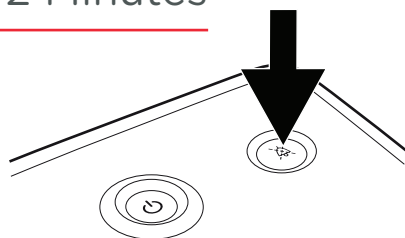

Press **Audio Pause Button**
for 3 seconds then press **OK**

Front Panel

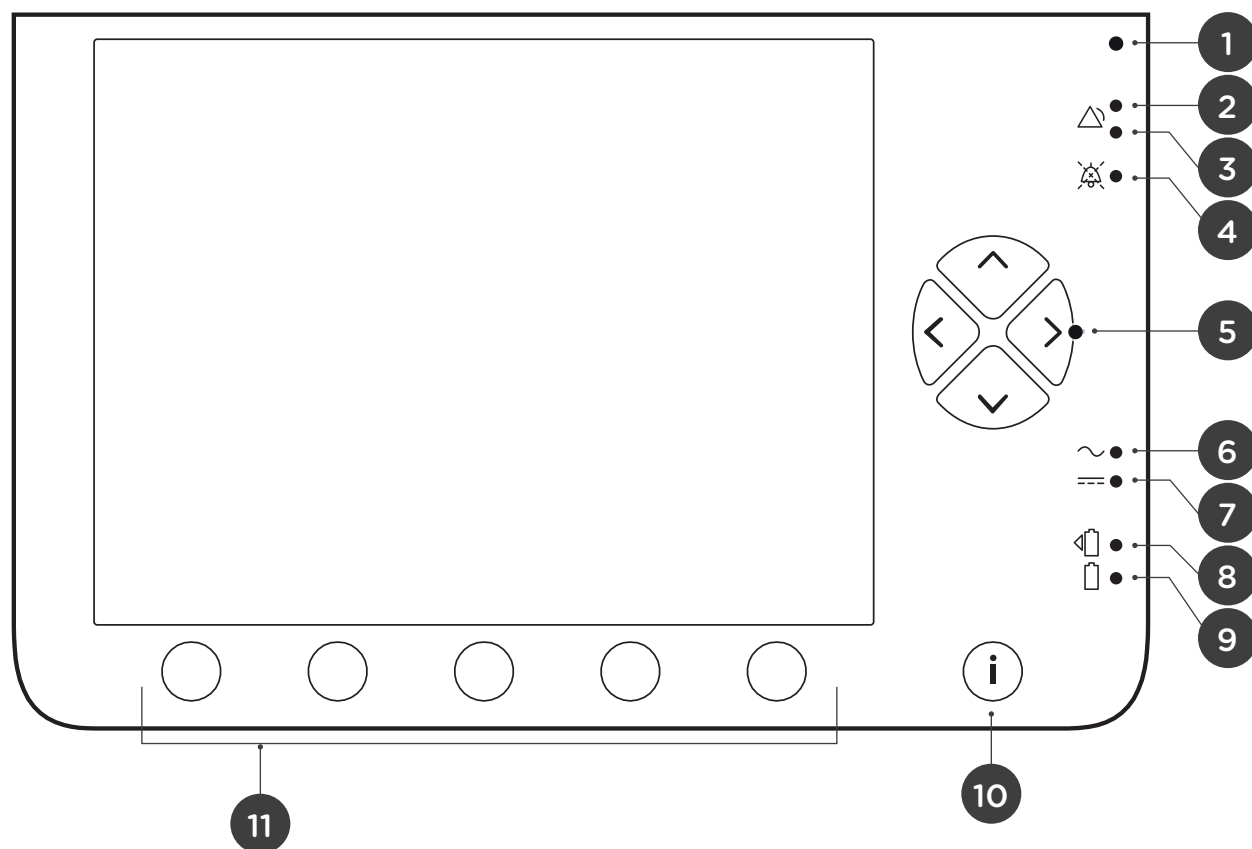

1 Ambient Light Sensor

2 3 Alarm LEDs =
Red is high priority;
Yellow medium priority

4 Audio Pause LED =
Paused alarm sound

5 Navigation / Setting Buttons =
Navigate display and define settings

6 Mains LED =
Connection to Mains Power

7 External DC LED =
Connection to External DC Power

8 Click-in battery LED =
Click-in battery is powering the unit

9 Internal battery LED =
Internal battery is powering the unit

10 Information "i" button =
Show or hide information texts

11 Navigation Menu Buttons =
Select menus

Main Display

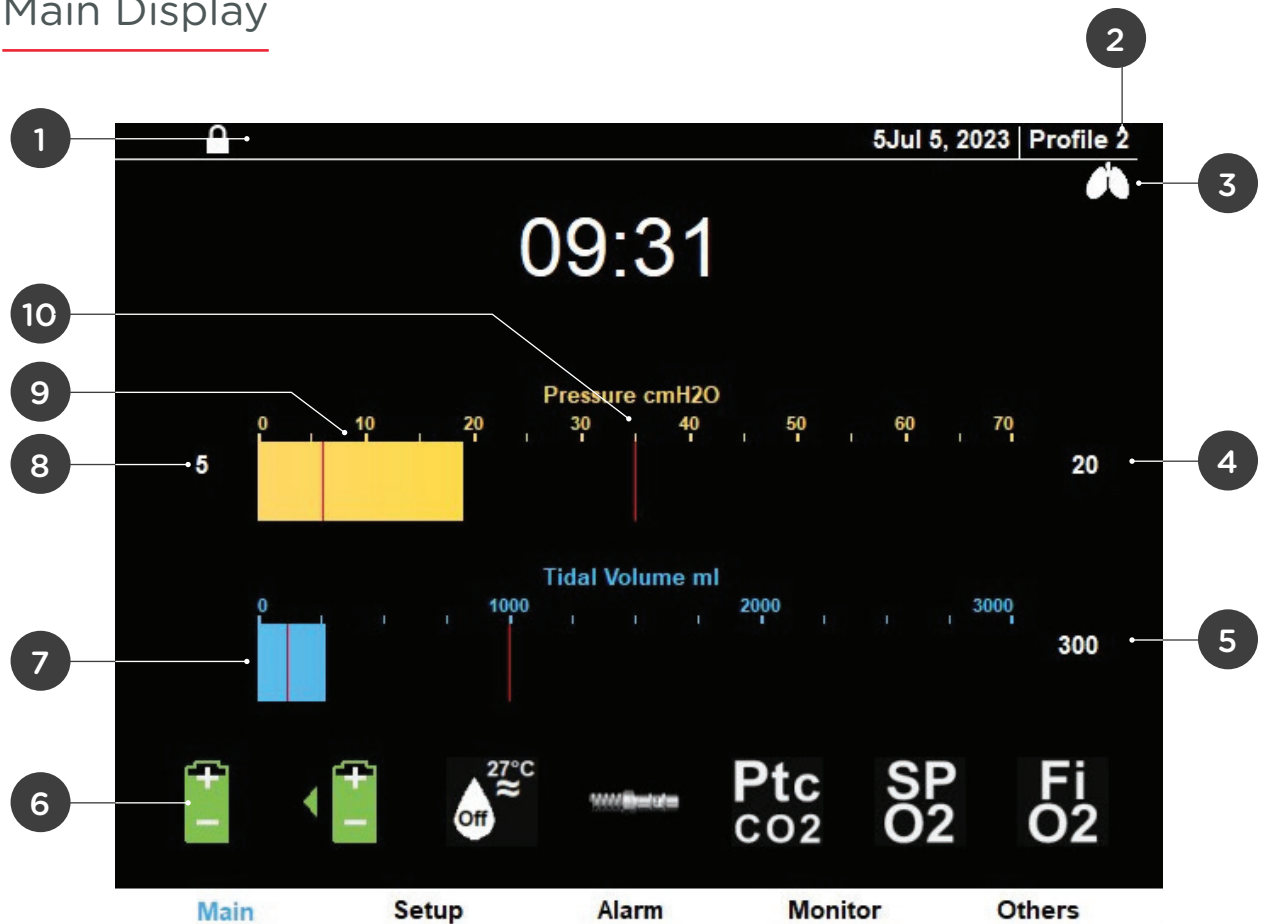

- 1 Home mode lock status
- 2 Profile in use
- 3 Patient triggered breath indicator
- 4 Peak (max pressure of last breath)
- 5 Tidal volume during last breath
- 6 Battery status and connected sensors
- 7 Bar graph of tidal volume
- 8 PEEP value
- 9 Bar graph of current pressure
- 10 Red lines in bar graphs are alarm limits

Menu Navigation

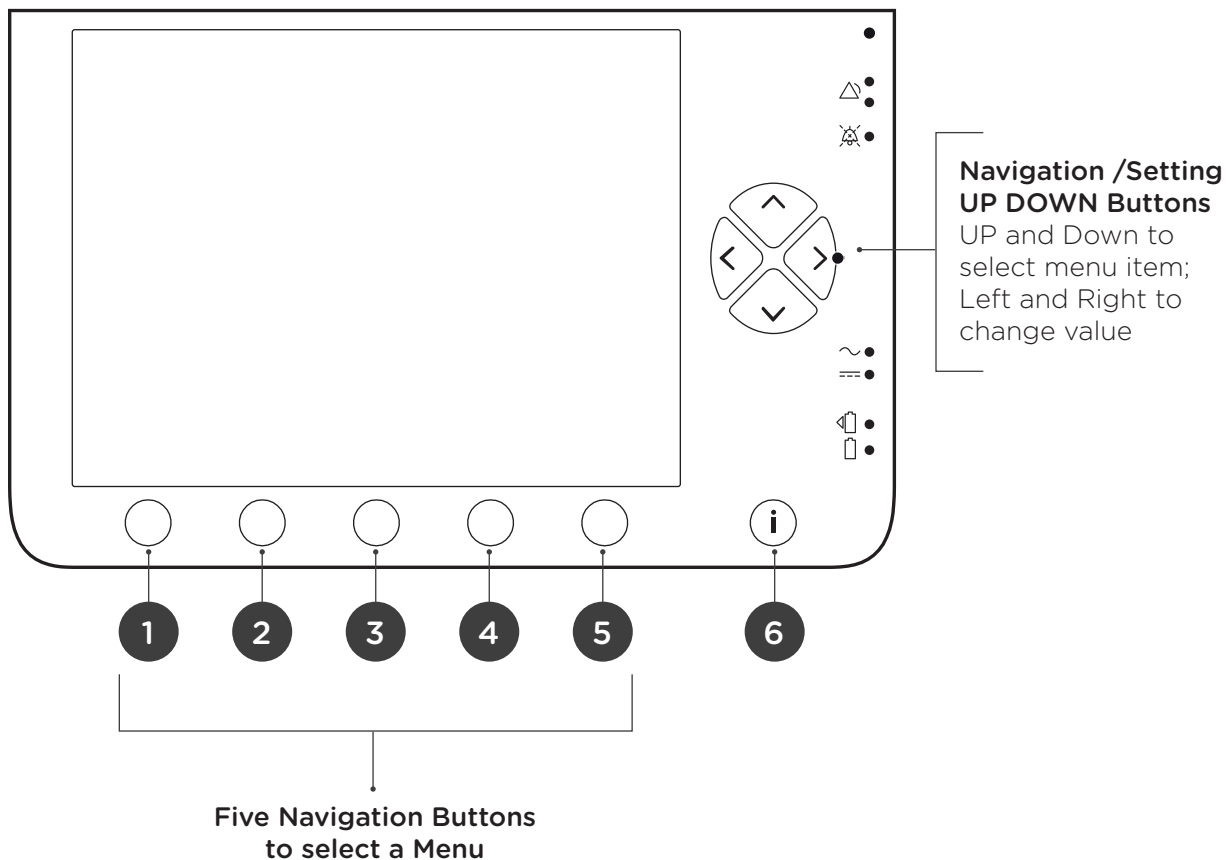

- ❶ **Main** = Clock, Battery Life
When **ventilation is on** = Pressure Bar and Volume Bar
- ❷ **Set up** = settings of ventilator (2 pages) - press two times
- ❸ **Alarm** = alarm settings (3 pages) - press button three times
- ❹ **Monitor** = breath to breath data / patient activity
- ❺ **Other** = miscellaneous information and options (humidifier settings adjustment)
- ❻ **i Button** = information given when information button is engaged / cursor highlighted area

Setup

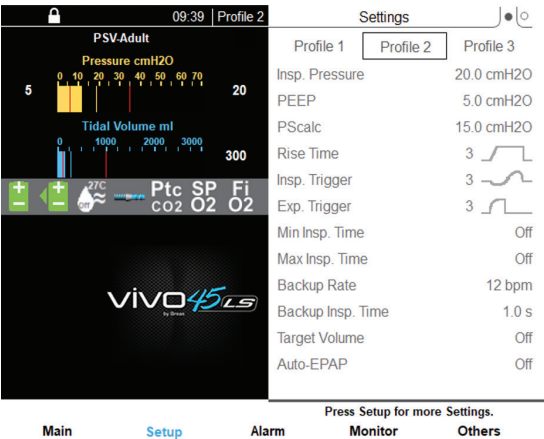

Press **Setup** to display current Ventilator settings

Alarm

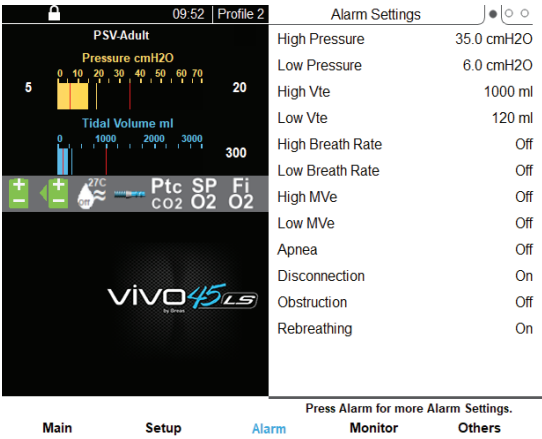

Press **Alarm** to display current Alarm settings

Monitor

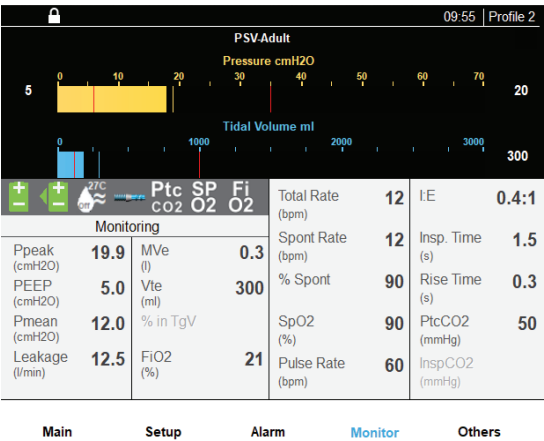





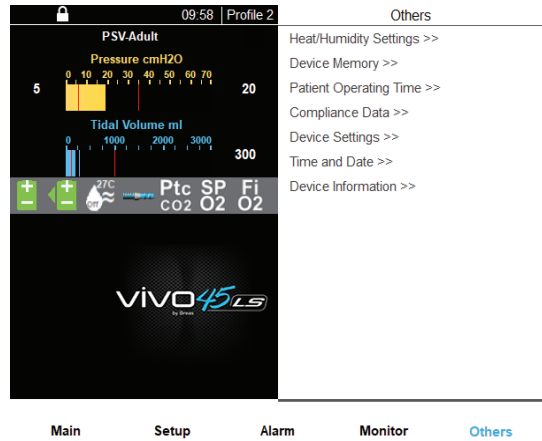



Press **Monitor** to display measured values

Others



Press **Others** to display additional ventilator settings and controls

Battery Status Indicators

	Internal	Click-In
> 50%		
20 - 50%		
< 20%		
DEAD		
% Charged	98%	98%
Est Run Time	2h 18m	

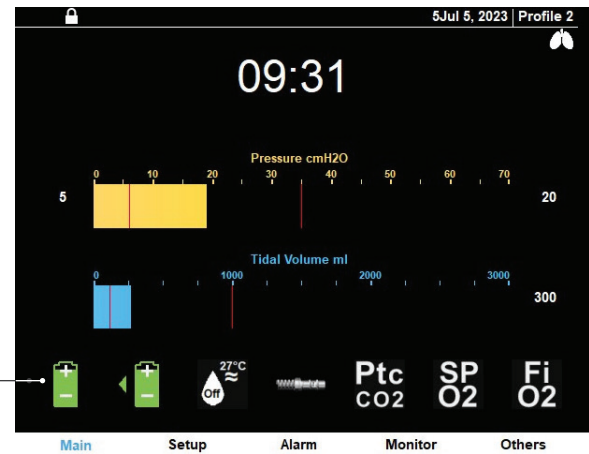

Common Alarms

Alarm	Cause	Fix
Low VtE	Leakage around mask or circuit	Ensure proper mask fit and circuit assembly
Disconnect	Circuit disconnection or huge leak	Ensure proper mask fit and circuit assembly
High VtE	<ul style="list-style-type: none"> Mismatch between selected and used patient circuit Inappropriate alarm setting 	<ul style="list-style-type: none"> Ensure circuit type used matches type shown on ventilator Contact health care provider
Low Pressure	<ul style="list-style-type: none"> Circuit disconnection or huge leak Inappropriate alarm setting 	<ul style="list-style-type: none"> Ensure proper mask fit and circuit assembly Contact health care provider
Humidifier/Bypass Loose	Air bypass unit or humidifier is not fully inserted into device	Push air bypass unit or humidifier into Vivo 45 LS until a "CLICK" is heard

How to Get Help with the i Button

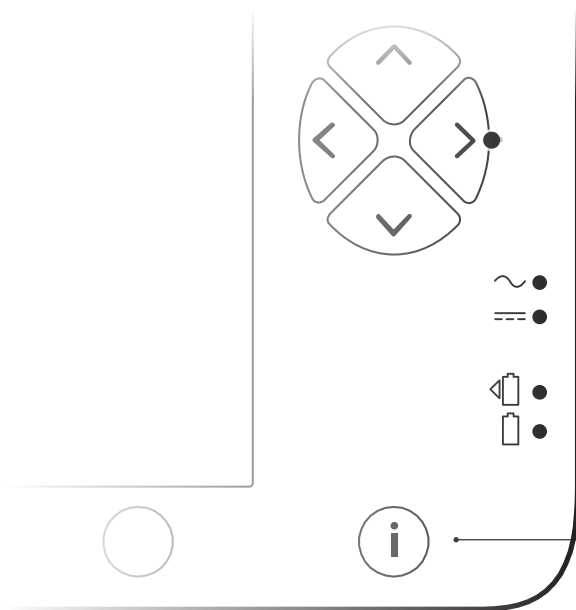

Use the **Information i Button** with the **Navigation / Setting Up and Down Buttons** to get help informational text about a selected display element.

Connecting Oxygen

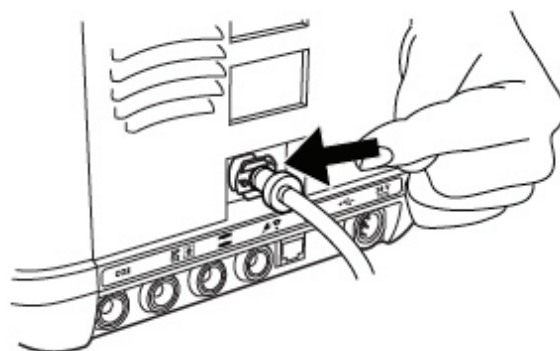
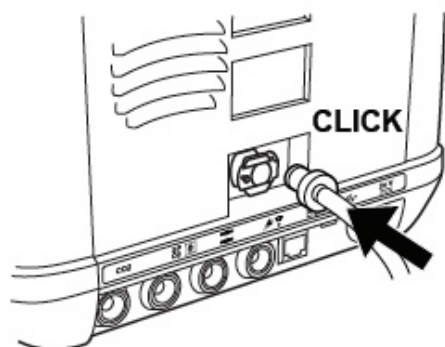

Connect oxygen tube to the oxygen inlet's adapter fitting on the back of the unit

Humidifier Water Chamber

Installing

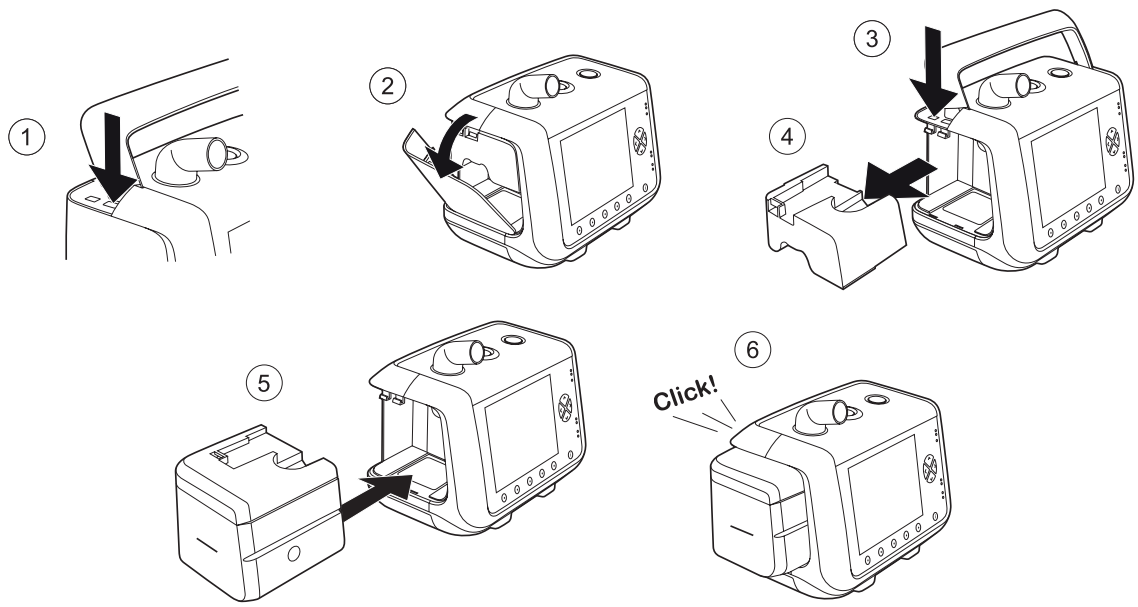

Filling

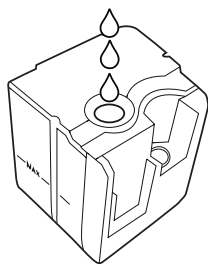

Add water to the chamber by filling through one of the airway connections.

Make sure not to fill above the Max indication. A water chamber filled to the maximum level contains approximately 350 ml.

You can also remove the lid and fill water through the top of the chamber.

Detaching

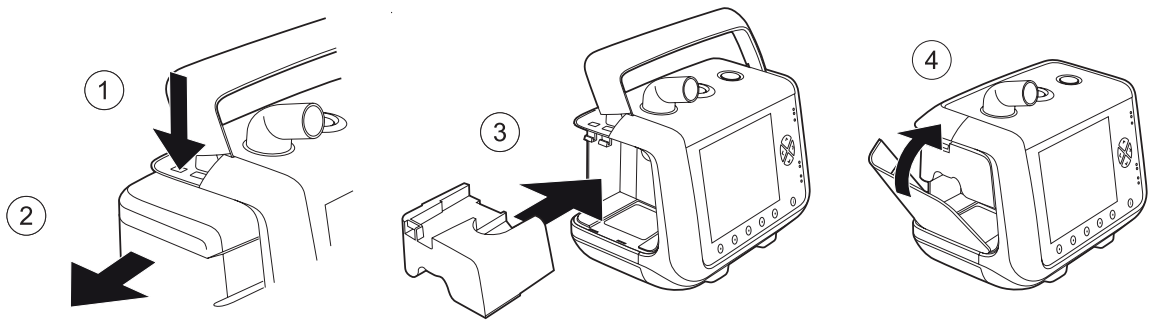

Humidifier Water Chamber

Opening/Closing

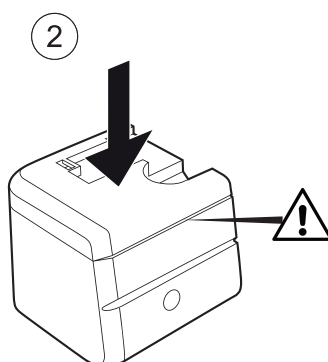
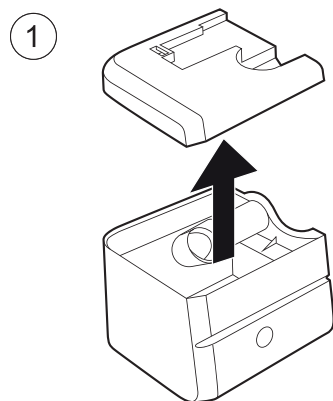

The water chamber lid shall be opened when manually emptying or cleaning the water chamber.



HELPFUL TIP:

When placing lid on water chamber, make sure lid is squarely situated above the water chamber and push straight down on each corner, ensuring the lid and chamber are completely sealed.



WARNING!

To avoid burn injury, be careful not to touch the heater plate or the heated water in the water chamber when the humidifier is switched on or has not yet cooled down. Wait 10 minutes for the heater plate and water to cool.



CAUTION!!

Always make sure the lid of the water chamber is totally sealed.

Cleaning

1. Open the water chamber by grasping the lid of the water chamber and lifting it straight up
2. Clean the parts of the humidifier chamber either by hand using a mild detergent or in a dishwasher without dishwasher detergent. Max temperature: 60°C (140°F)
3. If there are mineral deposits inside the water chamber, dissolve them using warm water and citric acid (i.e., lemon juice) for 30 minutes.



NOTE:

The cleaning and disinfection intervals should be established by the care provider, based on the care provider's infection control procedures.



Vivo by Breas is a trademark of Breas Medical AB. © 2024 Breas Medical – All rights reserved. Breas Medical reserves the right to make changes in specifications and features shown herein, or discontinue the product described at any time without notice or obligation. Contact your Breas representative for the most current information. Breas and the Breas logo are trademarks of Breas Medical AB. BOS-MAR-MAR-008082 Rev0

Breas Medical U.S. · 16 Esquire Road · N. Billerica, MA 01862 · USA · Phone +1 (855) 436-8724 · www.breas.com