

CLINICIAN GUIDE

VARIABLE THERAPY



OPTIONS

NOTE: Press **YES** at each field to advance to the next field. Pressing **YES** to ACCEPT OPT at the end of the menu is mandatory to confirm all changes made in the OPTIONS menu.

Lock: This is the security level setting. Press **YES** to accept or **NO** to change Lock Setting. Enter access code if prompted. Press **YES** to accept new setting.

HRLY TOT: This is the hourly infusion totals. Press **YES** to leave the screen off or **NO** to change to ON, then press **YES** to ON to view. Use the **UP/DOWN ARROW** keys to view the previous 24 hour totals. Press **NO** to exit the screen.

CLR HRLY: Press **YES** to leave the screen off or **NO** to change to ON, then press **YES** to ON to view. At the ACCEPT? YES/NO field, press **YES** to clear or **NO** to retain the Hourly Totals and exit the screen.

DN Occlu: This is the downstream occlusion sensitivity setting (default setting is LOW). Press **YES** to accept or **NO** to change then press **YES** to accept.

AIR SENS: This is the air-in-line sensitivity setting (default setting is 0.5 mL). Press **YES** to accept or **NO** to change then press **YES** to accept.

AUDIO: This is the audible volume control: Press **1-9** to hear level, press **YES** to accept the desired volume.

POWER CK: This is the power source with power graph. Press **YES** to leave the screen off or **NO** to change to ON, then press **YES** to ON to view the power graph. Screen automatically returns to OPTIONS menu after several seconds.

ACCEPT OPT: Press **YES** to accept any changes made. Pressing **NO** will cancel any setting changes.

CHANGING THE SOLUTION CONTAINER

1. Press the **PAUSE** key.
2. Change the solution container.
3. Highlight REPEAT RX, then press **YES**.
4. Highlight correct therapy if requested, then press **YES**.
5. If any on-screen alerts appear, press the **YES** key.
6. Note any on-screen ADVISORY and press **YES** to continue.
7. The program will auto-scroll (or confirm each field by pressing **YES**).
8. Press **RUN** to start the infusion.

CHANGING THE RX (BAG VOL, # DOSES, KVO, Amt TBI, RATE, TIME)

1. Press the **PAUSE** key.
2. Press **YES** to RESUME.
3. Press **NO** to review.
4. Press **YES** to each field until the value to change is reached.
5. At the desired field(s), enter the new program parameters (enter access code if prompted). If an access code was needed, enter the new parameters again. Press **YES** to confirm.
6. Press **YES** to all other highlighted areas if no other changes are to be made.
7. At DONE? press **YES**.
8. Press **RUN** to start the infusion.

TROUBLESHOOTING:

NOTE: For all alarms except "INFUSION COMPLETE", follow these instructions before proceeding to the RESOLUTION section below: To silence and exit Alarm/Alert screens, press the **PAUSE** key, press **YES** to RESUME, then resolve the alarm. When ready to resume the infusion, press **RUN** to start the infusion.

LCD DISPLAY/RESOLUTION/POSSIBLE CAUSES

INFUSION COMPLETE	Press PAUSE , attach new solution container, highlight REPEAT RX and press YES . The program will auto-scroll (or confirm each field by pressing YES). If therapy is complete, turn pump off.
AIR-IN-LINE	Press the PRIME key, then follow on-screen instructions to remove air from the tubing and IV bag. CAUTION: Disconnect set from patient's access site before priming. Sets with in-line ASVs must be primed on the pump.
ALARM DOWN OCCLUSION	Down occlusions auto-correct when occlusion is resolved without the need to press PAUSE . Check the tubing from pump to patient's IV site for cause, then correct obstruction per protocol. Consider changing the DN Occlu setting from LOW to HIGH (See OPTIONS section). Possible causes: kinked or clamped line, infiltrated/positional IV site, viscous solution, small gauge catheter.
ALARM UP OCCLUSION	Check tubing from pump to IV bag for cause, then correct obstruction per protocol. Possible causes: glass container without vented spike adapter, line kinked in pump door, bag empty, bag not spiked properly.
ALARM HIGH UP PRESSURE	Check for excessive pressure on IV bag. Causes: uneven fluid distribution within lockbox or carrying pouch, object pressing on solution container.
ALARM SET NOT INSTALLED	Use only Curlin administration sets. Check that set is installed properly. Refer to Instructions for Use in set package or Installing Administration Set section in this guide. Possible causes: tab not removed from yellow Flow-Stop, blue guide pin or yellow Flow-Stop not properly seated in receptacles, no set installed.
ALARM UNATTENDED	The pump will alarm when left idle for 2 minutes. Press RUN to start the infusion or press OFF to power down the pump.
ALARM REPLACE SET 3	Replace set and prime if necessary. Possible causes: flattening of the soft pumping segment of the set due to overuse, use of a glass container without a vented spike adapter, excessive plunger stiction with syringe use.
ALARM REPLACE SET 4	Equalize the pressure in the set by priming (disconnect from the patient). Turn pump OFF then ON to reset the sensor prior to resuming the infusion.
ALARM DOOR OPEN	Check placement of the administration set and close pump door properly. See User's Manual for instructions.
ALARM EMPTY BATTERY	Turn pump off by pressing the OFF key. Install 2 new batteries and turn pump back on.
ERROR CODE	If an error code occurs, turn pump off and consult provider or manufacturer.

MOOG®

Enhancing Healthcare. Enriching Lives.

REFER TO USER'S MANUAL FOR DETAILED INSTRUCTIONS
Clinical Support 1-800-970-2337
www.moog.com/medical

INSTALLING/CHANGING THE BATTERIES

1. PAUSE the pump.
2. Turn the pump OFF.
3. Open the battery door by sliding the gray “slider” to the right to the “UNLOCK” position and slide the door down to remove.
4. Remove old batteries from the top first. Insert new batteries bottom or flat side against the coils first, then push the top side into place.
5. Replace door and return slider to “LOCK” position and turn pump ON.
6. Press **YES** to PROGRAM (or LIBRARY if using the protocol LIBRARY).
7. Press **YES** to RESUME (or **YES** to Repeat RX if current container has not begun or if changing the container).
8. Press **RUN** to start.

INSTALLING THE ADMINISTRATION SET

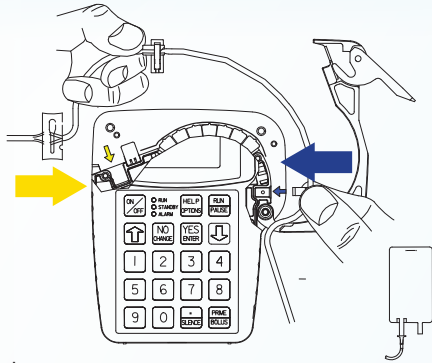

1. Open pump door.
2. Remove the old tubing.
3. Remove the new administration set from the package.
4. Twist and remove breakaway tab from YELLOW Flow-Stop.
5. Locate the BLUE and YELLOW arrows inside the pump as a reference point.
6. Insert the tubing using the reference points.
7. Ensure the tubing passes through the notch in front of the door hinge.
8. Center tubing over pumping fingers.
9. Close the door securely. Be sure top of door is flush with top of the pump.

PRIMING THE SET

CAUTION: Disconnect set from patient's access site before priming.

NOTE: Review program settings prior to priming.

NOTE: Filters must be primed in the upright position (do not invert). Refer to Instructions for Use in set package.

BY GRAVITY:

NOTE: To remove air from IV bag, turn bag upside down after attaching the set and gently squeeze bag while priming until air is eliminated from the bag.

1. Twist and remove breakaway tab from YELLOW Flow-Stop prior to connecting to solution container.
2. Squeeze YELLOW Flow-Stop between thumb and forefinger to allow fluid to flow through tubing.

BY PUMP:

NOTE: Therapy must be programmed and administration set must be installed into the pump prior to pump priming. Sets with in-line ASV must be primed on the pump.

1. Release any clamps on the administration set.
2. Press the **PRIME** key from the “RUN TO START” screen.
3. Press and hold the **PRIME** key until set is free of air; release **PRIME** key to stop (each prime cycle allows up to 6 mL of fluid).
4. Press the **YES** key to exit priming.

PROGRAMMING A VARIABLE THERAPY USING MANUAL PROGRAM MODE

NOTE: When operating the pump on battery power, the LCD screen dims after a period of time to conserve battery power. Any keypress will illuminate the screen.

NOTE: Use the **UP/DOWN ARROW** keys to move highlighter. Use the numeric keys for data entry.

1. Turn the pump ON and wait for the self-test to complete.
2. Highlight PROGRAM from the SELECT menu and press **YES**.
NOTE: The following screen (“NEW PROGRAM”) will not appear if the previous RX has been cleared from the pump. If this screen does not appear, skip to step #4.
3. Highlight NEW PROGRAM and press **YES**. Enter access code, if prompted.
4. Highlight VARIABLE from the therapy selection menu and press **YES**. If any on-screen alerts appear, press the **YES** key.
5. With Unidentified highlighted, press **YES** (this indicates Manual Programming Mode).
6. Select units: Press **YES** if units desired is indicated (choices are mg, mcg or mL). To change units press **NO** until desired unit is reached, then press **YES** to confirm. If mg or mcg is selected, enter the concentration and press **YES**.
7. Press **YES** to leave the Delayed Start Off, or press **NO** to set a delay and refer to the Delayed Start section.
8. At Next? Press **YES** to continue.
9. Enter Bag Volume, press **YES**.
10. Enter # DOSES, press **YES** (# DOSES is the number of rate changes or “steps” for the therapy).

NOTE: If a KVO rate of 0.1 to 10 mL is entered, the pump will give audible alerts every 20 minutes at the end of the infusion. Whereas if zero KVO is entered the pump will alarm every 3 seconds at the end of the infusion.

11. Enter KVO rate (if any), press **YES**.
12. At Next? Press **YES** to continue.
NOTE: To force an auto-calculation, enter any 2 of the 3 entries: Amt TBI, RATE or TIME, the unknown field will auto-calculate. Bypass the unknown field by using the **DOWN ARROW** key. Enter the known fields pressing **YES** to confirm each. The unknown field will auto-calculate. Press **YES** to confirm this field.
13. Enter Amt TBI (if known), press **YES**.
14. Enter RATE (if known), press **YES**.
15. Enter TIME (if known), press **YES**.
16. Continue pressing **YES** if needed until the NEXT? field is highlighted.
17. At Next? Press **YES** to continue.
18. Continue to enter Amt TBI, RATE and TIME for each of the subsequent doses, pressing **YES** to confirm each.

NOTE: If the remaining bag volume is to be infused on the final dose, enter the entire bag volume in the Amt TBI field. An Alert will appear on the screen, alerting the user the MAX amount that can be entered. When the final dose screen returns, enter the max amount listed into the Amt TBI field and press **YES** to confirm. Continue entering the RATE and TIME, pressing **YES** to confirm each.

19. At Next? Press **YES** to continue.
20. The last screen is the Summary screen. Press **YES** after TOT DOSES, TOT TIME and REQ VOL to confirm each value.
21. Press **YES** at DONE?

CAUTION:

Previous RX must be cleared from the pump prior to new patient use. Refer to the “CURLIN 6000 TRAINING & QUICK REFERENCE GUIDE FOR BETWEEN PATIENT USE” (Contact Customer Service for information).

PROGRAMMING A VARIABLE THERAPY USING PROTOCOL LIBRARY MODE

NOTE: When operating the pump on battery power, the LCD screen dims after a period of time to conserve battery power. Any keypress will illuminate the screen.

NOTE: Use the **UP/DOWN ARROW** keys to move highlighter. Use the numeric keys for data entry.

1. Turn the pump ON and wait for the self-test to complete.
2. Highlight LIBRARY from the SELECT menu and press **YES**.
3. Highlight NEW PROGRAM and press **YES**. Enter access code, if prompted.
NOTE: While YES is highlighted in the Page Down field, press **YES** to move to the next page while in the CAT (category) and DRG (drug) menus.
4. Highlight the desired CAT, press **YES**.
5. Highlight the desired DRG, press **YES**.
6. Press **YES** to ACCEPT?
7. If any on-screen alerts appear, press the **YES** key.
8. Note any on-screen ADVISORY and press **YES** to continue.
9. Press **YES** to confirm the dosing UNITS.
10. If a concentration is present, ensure the concentration matches the medication container. If correct, press **YES** to confirm.
11. Press **YES** to leave the Delayed Start Off, or press **NO** to set a delay and refer to the Delayed Start section.
12. At Next? press **YES** to continue.
13. Accept pre-programmed values for BAG VOL, # DOSES and KVO if they are correct, by pressing **YES** to each field.
14. If changes are needed to the pre-programmed values, highlight the desired field and press **NO**. Enter the correct value and press **YES**.
15. Continue as above until NEXT? Is highlighted.
16. At NEXT? press **YES** to continue.
17. Accept pre-programmed values for Amt TBI, RATE and TIME for each dose if they are correct, by pressing **YES** to each field.
18. If changes are needed to the pre-programmed values, highlight the desired field and press **NO**. Enter the correct value and press **YES**. At the NEXT? field in each dose, press **YES** to continue.
19. Press **YES** to each value in the summary screen: TOT DOSES, TOT TIME, REQ VOL.
20. Press **YES** at DONE?

“RUN TO START” SCREEN

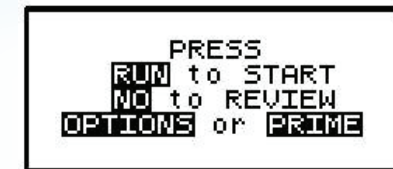

1. Press the **NO** key to review the program and/or change the RX (see CHANGING THE RX section for instructions).
2. Press the **OPTIONS** Key to review or change desired pump settings (see OPTIONS section for instructions).
3. Press the **PRIME** Key to prime the set (see Priming section for instructions).
4. Press **RUN** to start the infusion.

SETTING A DELAYED START

1. At the Delay field, press **NO** to OFF, then press **YES** to ON.
2. Enter Time infusion should begin (HH:MM), press **YES**.
3. Enter Date infusion should begin (MM/DD/YY), press **YES**.
4. Press **YES** to ACCEPT.